

**NOTICE OF MEETING
OF THE BOARD OF DIRECTORS OF THE
CHERRY HILLS NORTH METROPOLITAN DISTRICT**

March 6, 2015

Please take notice the meeting of the Board of Directors of the Cherry Hills North Metropolitan District will be held at Duffey's Patio Café, located at 4994 E Hampden Avenue, Denver, Colorado on Thursday, March 19, 2015 at 7:30 a.m. Business to be conducted at the meeting will include:

	<u>Page</u>
1. Public Comment	
2. Approval of the Minutes of the meeting held on January 8, 2015	1
3. Approval of the Compilation Report dated February 28, 2015	3
4. Payment of Expenditures March 12, 2015	7
5. Approval of Audit Exemption	8
6. Special District Prop/Liab Pool Sign Coverage	
7. Engineer's Report	14
8. Colorado 811 Membership	15
9. Old Business	
10. New Business	
11. Adjournment	

Next tentatively scheduled meetings:

April 9, 2015

May 14, 2014

June 11, 2015

RECORD OF PROCEEDINGS
THE BOARD OF DIRECTORS
CHERRY HILLS NORTH METROPOLITAN DISTRICT

A special meeting of the Board of Directors of Cherry Hills North Metropolitan District was held at Duffey's Bakery Patio Cafe, 4994 E. Hampden Avenue, Denver, Colorado 80110 at the hour of 7:30 a.m. on the 8th day of January 2015.

Present were: Dan Conway, Vice President
 Marcus McAskin, Secretary
 Keith Bierman, Director
 Darcy Beard, CPA

Director Conway noted that a quorum of the Board was present and therefore called the meeting of the Board of Directors of the Cherry Hills North Metropolitan District to order.

APPROVAL OF MINUTES

The minutes of the meeting held Thursday, November 13, 2014 were reviewed. Upon motion duly made, second and vote the minutes were approved.

FINANCIAL REPORT

Ms. Beard distributed the compilation report for the ten months ending December 31, 2014. After review, a motion was made by Director McAskin to accept the compilation reports. The motion was seconded by Director Bierman and upon vote, unanimously passed.

CASH DISBURSEMENTS

Ms. Beard presented the Schedule of Cash Disbursements totaling \$11,877.35. After review, Director McAskin made a motion to approve the cash disbursements. The motion was seconded by Director Bierman and upon vote unanimously approved.

MEETING MATTERS

Ms. Beard presented a proposed schedule of meeting dates for 2015. After discussion a motion was made by Director Conway to set the regular meeting on the 2nd Thursday of each month. The motion was seconded by Director McAskin and upon vote, unanimously approved.

Director Conway made a motion to establish the meeting place for 2015 at:

Duffey's Bakery Patio Cafe, 4994 E. Hampden Avenue, Denver, Colorado 80110.

The motion was seconded by Director McAskin and upon vote, unanimously approved.

Director Conway made a motion to establish the District posting locations as follows:

- 5130 Nassau Circle West, Cherry Hills Village, CO 80113
- 5232 Nassau Circle East, Cherry Hills Village, CO 80113
- 4051 South Holly Street, Cherry Hills Village, CO 80111

- Arapahoe County Clerk & Recorder Office
- Cherry Hills North Metro District Website, www.chvnorthmetro.us

The motion was seconded by Director McAskin and upon vote, unanimously approved.

AUDIT EXEMPTION PROPOSAL

Ms. Beard presented a proposal from L. Paul Goedecke P.C. to prepare the 2014 Audit Exemption for a fee of \$500. After review, Director Bierman made a motion to approve the Audit Exemption proposal. The motion was seconded by Director McAskin and upon vote, unanimously approved.

ENTRANCE SIGNS

Director McAskin suggested the Board work with the HOA to discuss responsibility of the entrance signs. Director Conway made a motion authorizing Director McAskin to work with the HOA to appoint a committee comprised of District Board members and HOA officers to make recommendations to the board on the signs and associated responsibilities. The Board directed Ms. Beard to contact the Special District Property and Liability Pool to inquire as to the annual increase in premium if the signs were added to the District's policy.

FEBRUARY MEETING

The Board cancelled the regularly scheduled meeting in February. The next meeting will be held on March 12, 2015.

ADJOURNMENT

There being no further business to come before the Board, and upon motion duly made, second and unanimously carried, the meeting was adjourned at 8:15 a.m.

MINUTES APPROVED:

Harold Roberts

Daniel Conway

Geoff Landry

Marcus McAskin

Keith Bierman

**DARCY BEARD
CERTIFIED PUBLIC ACCOUNTANT
20363 E. TOP-T RANCH PLACE
PARKER, COLORADO 80134
Office 303-841-3474
Fax 303-805-9188**

Accountant's Compilation Report

Board of Directors
Cherry Hills North Metropolitan District

I have compiled the accompanying Treasurer's Report of Cherry Hills North Metropolitan District and the related Statement of Net Assets and Statement of Revenues and Expenditures for the two months ending February 28, 2015. I have not audited or reviewed the accompanying financial statements and, accordingly, do not express an opinion or any form of assurance about whether the financial statements are in accordance with accounting principles generally accepted in the United States of America.

Management is responsible for the preparation and fair presentation of the financial statements in accordance with accounting principles generally accepted in the United States of America and for designing, implementing, and maintaining internal control relevant to the preparation and fair presentation of the financial statements.

My responsibility is to conduct the compilation in accordance with the Statements for Accounting and Review Services issued by the American Institute for Certified Public Accountants. The objective of a compilation is to assist management in presenting financial information in the form of financial statements without undertaking to obtain or provide any assurance that there are no material modifications that should be made to the financial statements.

Management has elected to omit substantially all the disclosures and the statement of cash flows required by accounting principles generally accepted in the United States of America. If the omitted disclosures were included in the financial statements, they might influence the user's conclusions about the company's assets, liabilities, equity, revenue and expenses. Accordingly, the financial statements are not designed for those who are not informed about such matters.

I am not independent with respect to Cherry Hills North Metropolitan District.

Darcy Beard
Certified Public Accountant
March 17, 2015

CHERRY HILLS NORTH METROPOLITAN DISTRICT
TREASURER'S REPORT

January 1, 2015 through February 28, 2015

<u>REVENUES</u>	ACTUAL 2015	BUDGET 2015	BUDGET REMAINING
Property Taxes	\$ 1,456.83	\$ 81,835	\$ 80,378.17
Ownership Taxes	535.29	3,000	2,464.71
Investment Income	10.05	400	389.95
	-	-	-
TOTAL REVENUES	\$ 2,002.17	\$ 85,235	\$ 83,232.83
<u>EXPENDITURES</u>			
Audit Expense	\$ 500.00	\$ 650	\$ 150.00
Accounting/Management Expense	1,456.00	10,300	8,844.00
County Fees	21.85	1,227	1,205.15
Dues	315.90	324	8.10
Election Expense	-	-	-
Insurance & Directors Bonds	1,559.89	1,799	239.11
Legal Fees	-	2,500	2,500.00
Engineering Expense	2,880.00	10,000	7,120.00
Miscellaneous	99.82	500	400.18
Utilities	247.09	2,520	2,272.91
Jet Flush, Video, Root Sawing	5,471.40	6,582	1,110.60
Repairs & Maintenance	-	5,000	5,000.00
Sewer Service Charge	5,515.00	22,060	16,545.00
Website Expenses	-	-	-
Capital Improvements	-	25,000	25,000.00
Outfall Line Expense	252.72	3,500	3,247.28
TOTAL EXPENDITURES	\$ 18,319.67	\$ 91,962	\$ 73,642.33

SEE ACCOMPANYING ACCOUNTANT'S REPORT.

CHERRY HILLS NORTH METROPOLITAN DISTRICT
STATEMENT OF NET ASSETS
FEBRUARY 28, 2015

ASSETS

First Bank Checking	\$ 7,343.30
First Bank Savings	227,469.11
ColoTrust	53,643.69
Outfall Line Reserve	975.00
Accrued Interest Receivable	-
Property Tax Receivable	80,378.17
Prepaid Insurance	-
Cash with County Treasurer	-
TOTAL ASSETS	<u>\$ 369,809.27</u>

LIABILITIES & NET ASSETS

Accounts Payable	\$ 9,351.21
Deferred Property Tax	<u>80,378.17</u>
Total Current Liabilities	\$ 89,729.38

NET ASSETS

Net Assets - Unrestricted	296,397.39
Change in Net Assets	<u>(16,317.50)</u>
Total Net Assets	<u>280,079.89</u>

TOTAL LIABILITIES & NET ASSETS	<u>\$ 369,809.27</u>
--------------------------------	----------------------

SEE ACCOMPANYING ACCOUNTANT'S REPORT.

CHERRY HILLS NORTH METROPOLITAN DISTRICT
STATEMENT OF REVENUES & EXPENDITURES
FOR THE TWO MONTHS ENDING FEBRUARY 28, 2015

REVENUES

Property Taxes	\$ 1,456.83
Ownership Taxes	535.29
Investment Income	<u>10.05</u>
TOTAL REVENUES	\$ 2,002.17

EXPENDITURES

Audit Expense	\$ 500.00
Accounting/Management Expense	1,456.00
Business Meetings	-
County Fees	21.85
Dues	315.90
Insurance & Directors Bonds	1,559.89
Legal Fees	-
Election Expense	-
Engineering	2,880.00
Miscellaneous	99.82
Utilities	247.09
Jet Flush	5,471.40
Repairs & Maintenance	-
Sewer Service Charge	5,515.00
Website Expenses	-
Capital Improvements	252.72
Outfall Committee	<u>-</u>
TOTAL EXPENDITURES	<u>\$ 18,319.67</u>
Change in Net Assets	\$ (16,317.50)
Net Assets - Beginning of Year	<u>\$ 296,397.39</u>
Net Assets - End of Month	<u>\$ 280,079.89</u>

SEE ACCOMPANYING ACCOUNTANT'S REPORT.

CHERRY HILLS NORTH METROPOLITAN DISTRICT
 CASH DISBURSEMENTS
 MARCH 19, 2015

<u>PAYEE</u>	<u>DESCRIPTION</u>	<u>CHECK NUMBER</u>	<u>AMOUNT</u>
Dale's Environmental Services	Jet Flush/Video	2399	\$ 5,471.40
Darcy Beard CPA	Acctg/Mgmt	2400	1,144.00
	Office Supplies		39.31
Hillcrest Water & Sanitation	Sewer Treatment	2401	5,515.00
Hillcrest Water & Sanitation	Outfall Line Maint	2402	252.72
L.Paul Goedecke	Audit Exemption	2403	500.00
Purrington Civil LLC	Engineering	2404	2,880.00
Xcel Energy	Utilities	2405	370.75
TOTAL CASH DISBURSEMENTS			<u>\$ 16,173.18</u>

SEE ACCOMPANYING ACCOUNTANT'S REPORT.

APPLICATION FOR EXEMPTION FROM AUDIT - SHORT FORM - FOR GOVERNMENTS WITH REVENUES AND EXPENDITURES OF \$100,000 OR LESS

Name of Government:	Cherry Hills North Metropolitan District	For the Year Ended December 31, 2014 or fiscal year ended:
Address:	C/O L. Paul Goedecke P.C. 950 Wadsworth Blvd. suite 204 Lakewood Colorado 80214	
Contact Person:	Paul Goedecke	
Telephone:	303-232-2866	
Email:	lpgcpa@qwestoffice.net	
Fax:		

Return to: Office of the State Auditor
Local Government Audit Division
1525 Sherman St., 7th Floor
Denver, CO 80203
Fax: 303-866-4062
Email: OSA.LG@state.co.us
Call (303) 869-3000 if you need help completing this form.

**PLEASE READ THE
ABOVE INSTRUCTIONS
BEFORE SUBMITTING**

Section 29-1-604, C.R.S., outlines the provisions for an exemption from audit. Generally, any local government for which neither revenues nor expenditures exceed \$500,000 in any year may qualify for an exemption. If either revenues or expenditures are \$100,000 or greater, but not more than \$500,000, you may NOT use this form. Please use the LONG FORM of this application. If both revenues and expenditures are less than \$100,000 individually, use this short form application for exemption from audit.

Please review ALL instructions prior to the completion of this form.

Instructions:

1. Prepare this form completely and accurately. Please note that there are 11 parts to this form, and all questions must be answered for the application to be considered complete.
2. File this form with the Office of the State Auditor within 3 months after the end of the year. For years ended December 31, the form **must** be received by the Office of the State Auditor by **March 31**.
3. The form **must** be completed by a person skilled in governmental accounting.
4. The application must be personally reviewed and approved by a majority of the governing body as evidenced by one of the following methods:
 - a. Resolution of the governing body - application may be emailed, faxed, or mailed.
 - b. Original signatures - application must be mailed. Email or fax will NOT be accepted.
5. The **preparer must sign** the application that is submitted in order for it to be accepted.
6. Additional information may be attached to the exemption at the preparer's discretion.

CERTIFICATION OF PREPARER

I certify that I am skilled in governmental accounting and that the information in the application is complete and accurate, to the best of my knowledge.

Name:	Louis Paul Goedecke
Title:	CPA
Firm Name (if applicable):	L. Paul Goedecke P.C.
Address:	950 Wadsworth Blvd. Suite 204 , Lakewood Colorado 80214
Telephone Number:	303-232-2866
Date Prepared:	2/13/2015

Preparer Signature (Required): The application will be rejected if not signed by the preparer.

L. Paul Goedecke P.C.

Please indicate whether the following financial information is recorded using Governmental or Proprietary fund types	Governmental	Proprietary
		x

Line#	Description	(Omit cents)
2-1	Taxes: Property	\$ 42,296
2-2	Specific ownership	\$ 2,756
2-3	Sales and use	\$ -
2-4	Other (specify):	\$ -
2-5	Licenses and permits	\$ -
2-6	Intergovernmental: Grants	\$ -
2-7	Conservation Trust Funds (Lottery)	\$ -
2-8	Highway Users Tax Funds (HUTF)	\$ -
2-9	Other (specify):	\$ -
2-10	Charges for services	\$ -
2-11	Fines and forfeits	\$ -
2-12	Special assessments	\$ -
2-13	Investment income	\$ 244
2-14	Charges for utility services	\$ -
2-15	Debt proceeds (should agree with line 4-3, column 2)	\$ -
2-16	Lease proceeds	\$ -
2-17	Developer Advances received (should agree with line 4-3)	\$ -
2-18	Proceeds from sale of capital assets	\$ -
2-19	Fire and police pension	\$ -
2-20	Donations	\$ -
2-21	Other (specify):	\$ -
2-22		\$ -
2-23		\$ -
2-24	(add lines 2-1 through 2-23) TOTAL REVENUE all sources	\$ 45,296

PART 3 - EXPENDITURES

EXPENDITURES: All expenditures for all funds must be reflected in this section, including the purchase of capital assets and principal and interest payments on long-term debt. Financial information will not include fund equity information.

Line#	Description	(Omit cents)
3-1	Administrative	FALSE
3-2	Salaries	\$ 8,879
3-3	Payroll taxes	\$ -
3-4	Contract services	\$ -
3-5	Employee benefits	\$ -
3-6	Insurance	\$ 1,713
3-7	Accounting and legal fees	\$ 11,307
3-8	Repair and maintenance	\$ 6,196
3-9	Supplies	\$ -
3-10	Utilities and telephone	\$ 2,218
3-11	Fire/Police	\$ -
3-12	Streets and highways	\$ -
3-13	Public health	\$ -
3-14	Culture and recreation	\$ -
3-15	Utility operations	\$ 21,911
3-16	Capital outlay (should agree with Part 6)	\$ -
3-17	Debt service principal (should agree with Part 4)	\$ -
3-18	Debt service interest	\$ -
3-19	Repayment of Developer Advances (should agree with line 4-3)	\$ -
3-20	Contribution to pension plan (should agree to line 7-2)	\$ -
3-21	Contribution to Fire & Police Pension Assoc. (should agree to line 7-2)	\$ -
3-22	Other (specify): Engineering	\$ 10,032
3-23	County Treasurers fee	\$ 636
3-24	Miscellaneous	\$ 20
3-25	(add lines 3-1 through 3-24) TOTAL EXPENDITURES all categories	\$ 62,912

Note: If Total Revenue (Line 2-24) or Total Expenditures (Line 3-25) are greater than \$100,000 - STOP. You may not use this form. Please use the "Application for Exemption from Audit - Long Form".

PART 4 - DEBT OUTSTANDING, ISSUED, AND RETIRED						
Please answer the following questions by marking the appropriate boxes.					Yes	No
4-1	Does the entity have outstanding debt?					x
	Is the debt repayment schedule attached? If no, please explain:					
4-2	Is the entity current in its debt service payments? If no, please explain:					na
4-3	Please complete the following debt schedule, if applicable: (please only include principal amounts)		Outstanding at end of prior year	Issued during year	Retired during year	Outstanding at year-end
	General obligation bonds		\$ -	\$ -	\$ -	\$ -
	Revenue bonds		\$ -	\$ -	\$ -	\$ -
	Notes/Loans		\$ -	\$ -	\$ -	\$ -
	Leases		\$ -	\$ -	\$ -	\$ -
	Developer Advances		\$ -	\$ -	\$ -	\$ -
	Other (specify):		\$ -	\$ -	\$ -	\$ -
	Total:		\$ -	\$ -	\$ -	\$ -
Please answer the following questions by marking the appropriate boxes.					Yes	No
4-4	Does the entity have any authorized, but unissued, debt?					x
If yes:	How much?	\$ -				
	Date the debt was authorized:					
4-5	Does the entity intend to issue debt within the next calendar year?					x
If yes:	How much?	\$ -				
Please answer the following questions by marking the appropriate boxes.					Yes	No
4-6	Does the entity have debt that has been refinanced that it is still responsible for?					x
If yes:	What is the amount outstanding?	\$ -				
Please answer the following questions by marking the appropriate boxes.					Yes	No
4-7	Does the entity have any lease agreements?					x
If yes:	What is being leased?					
	What is the original date of the lease?					
	Number of years of lease?					
	Is the lease subject to annual appropriation?					na
	What are the annual lease payments?	\$ -				
4-8	Please use this space to provide any explanations or comments:					

PART 5 - CASH AND INVESTMENTS

Please provide the entity's cash deposit and investment balances.				Amount	Total	
5-1	Checking accounts			\$ 245,757		
5-2	Savings accounts			\$ 1,001		
5-3	Certificates of deposit			\$ -		
	Total Cash Deposits				\$ 246,758	
	Investments (if investment is a mutual fund, please list underlying investments):					
5-4	colotrust			\$ 51,375		
5-5				\$ -		
5-6				\$ -		
5-7				\$ -		
	Total Investments				\$ 51,375	
	Total Cash and Investments				\$ 298,133	
Please answer the following question by marking in the appropriate box				Yes	No	
5-8	Are the entity's deposits in an eligible (Public Deposit Protection Act) public depository (Section 11-10.5-101, et seq. C.R.S.)? If no, please explain:				x	
5-9	Please use this space to provide any explanations or comments:					

PART 6 - CAPITAL ASSETS

Please answer the following questions by marking in the appropriate boxes.		Yes	No
6-1	Does the entity have capital assets?	x	
If yes:	Has the entity performed an annual inventory of capital assets in accordance with Section 29-1-506, C.R.S.? If no, please explain: all assets have been are fully depreciated and no additonal assets of years.		x
Complete the following table:			
		Balance - beginning of the year	Additions
		Deletions	Year-End Balance
	Land	\$ -	\$ -
	Buildings	\$ -	\$ -
	Machinery and equipment	\$ -	\$ -
	Furniture and fixtures	\$ -	\$ -
	Construction In Progress (CIP)	\$ -	\$ -
	Other (explain): Property and equipment	\$ 144,318	\$ -
	Accumulated Depreciation	\$ (144,318)	\$ -
	Total	\$ -	\$ -
6-2	Please use this space to provide any explanations or comments:		

PART 7 - PENSION INFORMATION

Please answer the following questions by marking in the appropriate boxes.		Yes	No
7-1	Does the entity have an "old hire" firemen's pension plan?		x
7-2	Does the entity have a volunteer firemen's pension plan?		x
If yes:	Who administers the plan?		
	Indicate the contributions from:		
	Tax (property, SO, sales, etc.):	\$ -	
	State contribution amount:	\$ -	
	Other (gifts, donations, etc.):	\$ -	
	Total:	\$ -	
	What is the monthly benefit paid for 20 years of service per retiree as of Jan 1?	\$ -	
7-3	Please use this space to provide any explanations or comments:		

PART 8 - BUDGET INFORMATION

Please answer the following questions by marking in the appropriate boxes.		Yes	No
8-1	Did the entity file a budget with the Department of Local Affairs for the current year? If no, please	x	
8-2	Did the entity pass an appropriations resolution? In no, please explain:	x	
If yes:	Please indicate the amount appropriated for each fund for the year:		
	Fund Name	Budgeted Expenditures	
	Enterprise fund	\$	84,816
8-3	Please use this space to provide any explanations or comments:		

PART 9 - TAX PAYER'S BILL OF RIGHTS (TABOR)

Please answer the following question by marking in the appropriate box		Yes	No
9-1	Is the entity in compliance with all the provisions of TABOR [State Constitution, Article X, Section 20(5)]?	x	
Note: An election to exempt the government from the spending limitations of TABOR does not exempt the government from the 3 percent emergency reserve requirement. All governments should determine if they meet this requirement of TABOR.			
9-2	Please use this space to provide any explanations or comments:		

PART 10 - GENERAL INFORMATION

Please answer the following questions by marking in the appropriate boxes.		Yes	No
10-1	Is this application for a newly formed governmental entity?		x
If yes:	Date of formation:		
10-2	Has the entity changed its name in the past or current year?		x
If Yes:	Please list the NEW name & PRIOR name:		
10-3	Is the entity a metropolitan district?	x	
10-4	Please indicate what services the entity provides: maintenance services		
10-5	Does the entity have an agreement with another government to provide services?		x
If yes:	List the name of the other governmental entity and the services provided:		
10-6	Has the district filed a <i>Title 32, Article 1 Special District Notice of Inactive Status</i> during the year? [Applicable to Title 32 special districts only, pursuant to Sections 32-1-103 (9.3) and 32-1-104 (3), C.R.S.]		x
If yes:	Date Filed:		
10-7	Please use this space to provide any explanations or comments:		

PART 11 - GOVERNING BODY APPROVAL

Below is the certification and approval of the governing board. By signing the board member is certifying they are a duly elected or appointed officer of the local government. Governing board members may be verified. Also by signing, the board member certifies that this Application for Exemption from Audit has been prepared consistent with Section 29-1-604, C.R.S., which states that a governmental agency with revenue and expenditures of \$100,000 or less must have an application prepared by a person skilled in governmental accounting; completed to the best of their knowledge and is accurate and true. Use additional pages if needed.

Print the names of all current		A MAJORITY of the governing board members must complete and sign in the column
Board Member 1	Print Board Members Name	I _____, attest I am a duly elected or appointed board member and I have reviewed and approve the application for exemption from audit.
	Harold Roberts	Signed _____ Date: _____ My term Expires: <u>5/2016</u>
Board Member 2	Print Board Members Name	I _____, attest I am a duly elected or appointed board member and I have reviewed and approve the application for exemption from audit.
	Daniel Conway	Signed _____ Date: _____ My term Expires: <u>5/2016</u>
Board Member 3	Print Board Members Name	I _____, attest I am a duly elected or appointed board member and I have reviewed and approve the application for exemption from audit.
	<u>Geoff Landry</u> Robert Samuels	Signed _____ Date: _____ My term Expires: <u>5/2018</u>
Board Member 4	Print Board Members Name	I _____, attest I am a duly elected or appointed board member and I have reviewed and approve the application for exemption from audit.
	<u>Marcus McAskin</u> David Cooper	Signed _____ Date: _____ My term Expires: <u>5/2018</u>
Board Member 5	Print Board Members Name	I _____, attest I am a duly elected or appointed board member and I have reviewed and approve the application for exemption from audit.
	<u>Keith Bierman</u>	Signed _____ Date: _____ My term Expires: <u>5/2018</u>
Board Member 6	Print Board Members Name	I _____, attest I am a duly elected or appointed board member and I have reviewed and approve the application for exemption from audit.
		Signed _____ Date: _____ My term Expires: _____
Board Member 7	Print Board Members Name	I _____, attest I am a duly elected or appointed board member and I have reviewed and approve the application for exemption from audit.
		Signed _____ Date: _____ My term Expires: _____

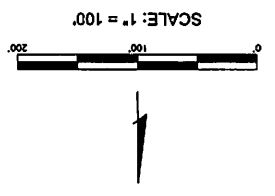

VIDEO RESULTS LEGEND

2014/2015 VIDEO PROGRAM
CODE X FCS STRUCTURAL GRADE

- CODE
- CH(1) = CRACK HINGE (# OF CRACKS)
- CM = CRACK MULTIPLE
- CS = CRACK SPIRAL
- DH = DEFORMED HORIZONTALLY
- DAE = DEPOSITS ATTACHED ENCUSTATION
- DAGS = DEPOSITS ATTACHED GREASE
- DSEF = DEPOSITS SETTLED FINE
- E = ENCUSTATION
- ISSR = INTRUDING SEALING RING
- TS1 = TAP SADDLE INTRUDING
- TS2 = TAP SADDLE INTRUDING
- TS3 = TAP SADDLE INTRUDING
- TS4 = TAP SADDLE INTRUDING
- TS5 = TAP SADDLE INTRUDING
- TS6 = TAP SADDLE INTRUDING
- TS7 = TAP SADDLE INTRUDING
- TS8 = TAP SADDLE INTRUDING
- TS9 = TAP SADDLE INTRUDING
- TS10 = TAP SADDLE INTRUDING
- TS11 = TAP SADDLE INTRUDING
- TS12 = TAP SADDLE INTRUDING
- TS13 = TAP SADDLE INTRUDING
- TS14 = TAP SADDLE INTRUDING
- TS15 = TAP SADDLE INTRUDING
- TS16 = TAP SADDLE INTRUDING
- TS17 = TAP SADDLE INTRUDING
- TS18 = TAP SADDLE INTRUDING
- TS19 = TAP SADDLE INTRUDING
- TS20 = TAP SADDLE INTRUDING
- TS21 = TAP SADDLE INTRUDING
- TS22 = TAP SADDLE INTRUDING
- TS23 = TAP SADDLE INTRUDING
- TS24 = TAP SADDLE INTRUDING
- TS25 = TAP SADDLE INTRUDING
- TS26 = TAP SADDLE INTRUDING
- TS27 = TAP SADDLE INTRUDING
- TS28 = TAP SADDLE INTRUDING
- TS29 = TAP SADDLE INTRUDING
- TS30 = TAP SADDLE INTRUDING
- TS31 = TAP SADDLE INTRUDING
- TS32 = TAP SADDLE INTRUDING
- TS33 = TAP SADDLE INTRUDING
- TS34 = TAP SADDLE INTRUDING
- TS35 = TAP SADDLE INTRUDING
- TS36 = TAP SADDLE INTRUDING
- TS37 = TAP SADDLE INTRUDING
- TS38 = TAP SADDLE INTRUDING
- TS39 = TAP SADDLE INTRUDING
- TS40 = TAP SADDLE INTRUDING
- TS41 = TAP SADDLE INTRUDING
- TS42 = TAP SADDLE INTRUDING
- TS43 = TAP SADDLE INTRUDING
- TS44 = TAP SADDLE INTRUDING
- TS45 = TAP SADDLE INTRUDING
- TS46 = TAP SADDLE INTRUDING
- TS47 = TAP SADDLE INTRUDING
- TS48 = TAP SADDLE INTRUDING
- TS49 = TAP SADDLE INTRUDING
- TS50 = TAP SADDLE INTRUDING
- TS51 = TAP SADDLE INTRUDING
- TS52 = TAP SADDLE INTRUDING
- TS53 = TAP SADDLE INTRUDING
- TS54 = TAP SADDLE INTRUDING
- TS55 = TAP SADDLE INTRUDING
- TS56 = TAP SADDLE INTRUDING
- TS57 = TAP SADDLE INTRUDING
- TS58 = TAP SADDLE INTRUDING
- TS59 = TAP SADDLE INTRUDING
- TS60 = TAP SADDLE INTRUDING
- TS61 = TAP SADDLE INTRUDING
- TS62 = TAP SADDLE INTRUDING
- TS63 = TAP SADDLE INTRUDING
- TS64 = TAP SADDLE INTRUDING
- TS65 = TAP SADDLE INTRUDING
- TS66 = TAP SADDLE INTRUDING
- TS67 = TAP SADDLE INTRUDING
- TS68 = TAP SADDLE INTRUDING
- TS69 = TAP SADDLE INTRUDING
- TS70 = TAP SADDLE INTRUDING
- TS71 = TAP SADDLE INTRUDING
- TS72 = TAP SADDLE INTRUDING
- TS73 = TAP SADDLE INTRUDING
- TS74 = TAP SADDLE INTRUDING
- TS75 = TAP SADDLE INTRUDING
- TS76 = TAP SADDLE INTRUDING
- TS77 = TAP SADDLE INTRUDING
- TS78 = TAP SADDLE INTRUDING
- TS79 = TAP SADDLE INTRUDING
- TS80 = TAP SADDLE INTRUDING
- TS81 = TAP SADDLE INTRUDING
- TS82 = TAP SADDLE INTRUDING
- TS83 = TAP SADDLE INTRUDING
- TS84 = TAP SADDLE INTRUDING
- TS85 = TAP SADDLE INTRUDING
- TS86 = TAP SADDLE INTRUDING
- TS87 = TAP SADDLE INTRUDING
- TS88 = TAP SADDLE INTRUDING
- TS89 = TAP SADDLE INTRUDING
- TS90 = TAP SADDLE INTRUDING
- TS91 = TAP SADDLE INTRUDING
- TS92 = TAP SADDLE INTRUDING
- TS93 = TAP SADDLE INTRUDING
- TS94 = TAP SADDLE INTRUDING
- TS95 = TAP SADDLE INTRUDING
- TS96 = TAP SADDLE INTRUDING
- TS97 = TAP SADDLE INTRUDING
- TS98 = TAP SADDLE INTRUDING
- TS99 = TAP SADDLE INTRUDING
- TS100 = TAP SADDLE INTRUDING

MAINTENANCE SCHEDULE LEGEND

YEAR RECORDED

2014	2015
WEST BASIN	EAST BASIN
VIDEO PROGRAM	VIDEO PROGRAM

CHERRY HILLS NORTH METROPOLITAN DISTRICT

1 OF 1

PIPE CONDITION

DEFECTS MAP

SCALE AS NOTED

PURINGTON

CIVIL, LLC

1158 BERKSHIRE PASADENA
DENVER, CO 80202

TEL: 303.531.2233
WWW.PURINGTONCIVIL.COM

CHERRY HILLS NORTH
METROPOLITAN
DISTRICT

DATE	REVISION	BY

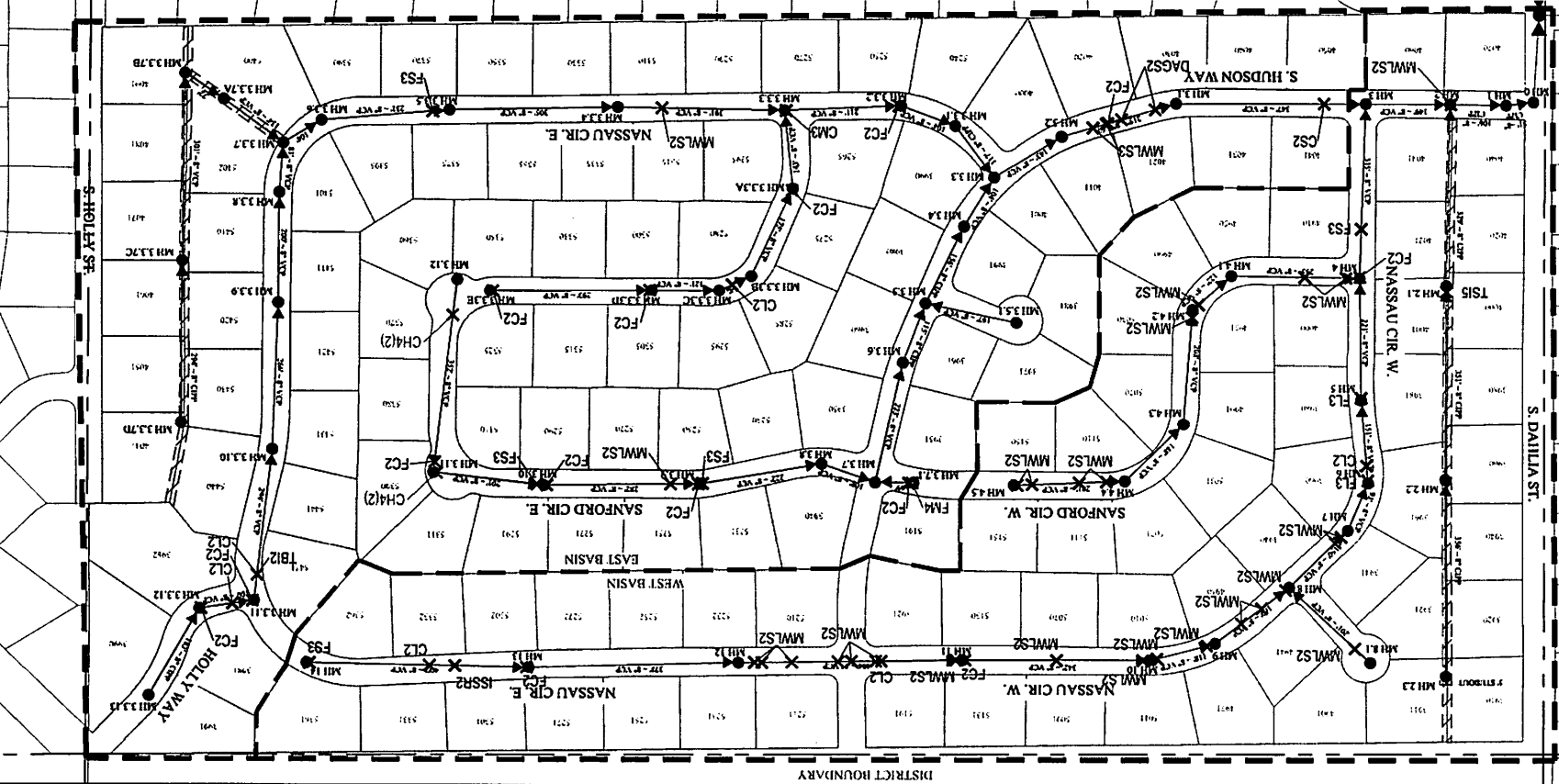

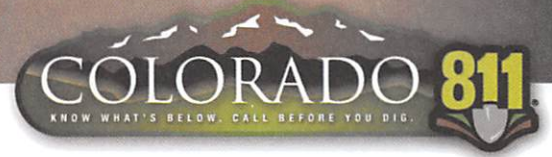

DATE: January 12, 2015
TO: Cherry Hills North Water & Sanitation
FROM: Sandy Samuelson, CO811 Member Liaison

During 2014, your organization requested information for membership at Colorado 811. The State of Colorado mandates that "Every owner or operator of an underground facility in this state shall join the notification association" Colorado 811. This portion is located in 9-1.5-101. The definition of an owner or operator is: "Operator" or "owner" means any person, including public utilities, municipal corporations, political subdivisions, or other persons having the right to bury underground facilities in or near a public road, street, alley, right-of-way, or utility easement. This portion is located in 9-1.5-104.5; (1)(a). A copy of the law, in its' entirety, is accessible at www.co811.org. Please select "Resources" for a full copy of Title 9 Safety- Industrial and Commercial Article 1.5 Excavation Requirements. The law consists of information contained in State Statute 9-1.5-101-107.

This letter serves as a reminder that you may, based on the description above, still need to become a member at Colorado 811. In the law, it refers to penalties that can be assessed by the aggrieved party to an underground facility owner for not being a member, or if damaged, that is not a member. The penalty structure is as follows:

- Non membership/participation can be penalized with a civil penalty of \$200.00.
- If the underground facility of the non-member is damaged the facility owner can be penalized \$5,000.00 for the first offense.
- Should the non-member sustain an additional damage within a 12-month period penalties can be imposed of up to \$25,000.00.
- If more than 3 separate occasions of damage occur within a 12-month period the penalties can go up to \$75,000.00.

A membership at Colorado 811 fulfills the above-mentioned statute, but also provides a more secure system for damage prevention, allowing excavators in the State to know what is below prior to excavation. For the safety of your underground facility and the safety of those that may excavate in the vicinity of the underground facility, a membership needs to be completed. If an additional member application is needed, please contact Colorado 811 for further information.

We look forward to serving you.

Sandy Samuelson
CO811 Member Liaison
303-205-6305, office
303-513-7616, cell
samuelsan@co811.org